

Chevron Blade Louver in 2" deep frame design Model LEY-02

Design Features – Vision proof blade in narrow profile frame offers a clean fine lines appearance.

STANDARD CONSTRUCTION

ALL MATERIAL – EXTRUDED ALUMINUM 6063-T5 (KB-45)

FRAME

.063" thk. (1.6) extruded aluminum in style #3.

BLADES

.050" thk. (1.3) extruded aluminum, approx. spacing is 1-1/2" (38) o.c.

MAXIMUM SIZE

Unlimited, with mullions, structural bracing supplied by others

MAXIMUM FACTORY ASSEMBLY SIZE

120" w x 84" h" or 84" h x 120" w

(Type of finish may limit maximum single section)

MULLION

Invisible

MINIMUM SIZE

12" w x 12" h (305 x 305)

UNDERSIZED

1/4" (6) under ordered size unless specified Exact or Actual

SCREEN

3/4" x .051" (19 x 1.3) flattened expanded aluminum bird screen

FINISH

Mill

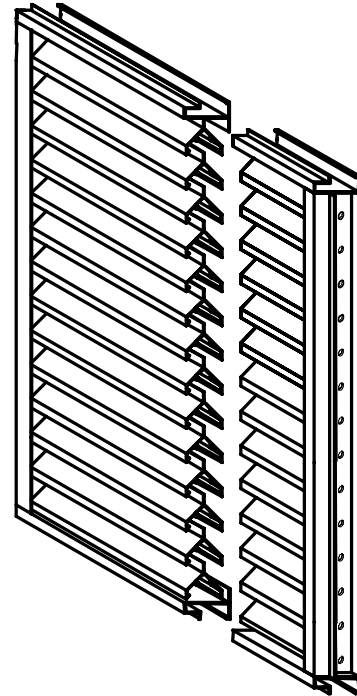

OPTIONAL CONSTRUCTION

SCREEN - Many styles available please consult screen listing

FINISH – Air-dry primer, polyurethane, epoxy, or enamel, baked epoxy or enamel, Kynar, or Powder coat.

MULLION – Visible for architectural preference

SPECIAL PURPOSE CONSTRUCTION

Special shapes: Triangle, Round, Trapezoid, etc.

Fully welded construction

Security bars

Hinged as walk through door or swing out access

Filter racks

Sleeved for ductwork connection

** Consult SAFE-AIR/DOWCO for additional technical information.

MULLION STYLES

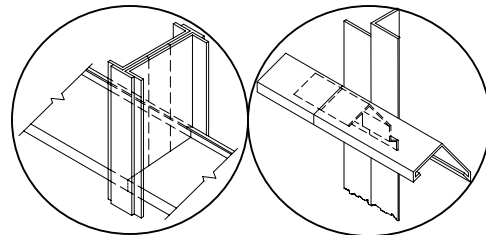

Visible

Invisible

TYPICAL SCREEN STYLES

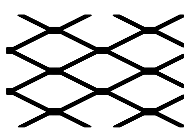

Expanded Aluminum Standard

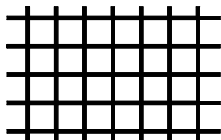

Wire Mesh

FRAME STYLES

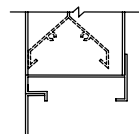

(1) - Flange 1-1/2"

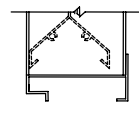

(3) - Box Standard

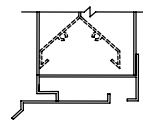

(8) - Box and Sill Extension

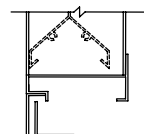

(9) - Flange w/ sub frame

DATE	ARCHITECT			CUSTOMER
PROJECT				
ITEM	QTY	W	H	DESCRIPTION



DEPENDABLE PRODUCTS SINCE 1955

SAFE-AIR OF ILLINOIS INC.

Engineering and General Offices

1855 South 54th Avenue, Cicero, Illinois 60804

Phone 708-652-9100 FAX 708-652-9158

WIDTH FREE AREA CALCULATIONS IN SQ. FT.

INCHES	12	18	24	30	36	42	48	54	60	66	72	78	84	90	96
12	.28	.44	.59	.74	.90	1.05	1.20	1.36	1.51	1.66	1.82	1.97	2.12	2.27	2.43
18	.45	.69	.93	1.17	1.41	1.65	1.89	2.13	2.37	2.61	2.85	3.09	3.33	3.57	3.81
24	.61	.94	1.26	1.59	1.92	2.25	2.58	2.91	3.23	3.56	3.89	4.22	4.55	4.87	5.20
30	.77	1.19	1.60	2.02	2.43	2.85	3.26	3.68	4.10	4.51	4.93	5.34	5.76	6.17	6.59
36	.93	1.44	1.94	2.44	2.94	3.45	3.95	4.45	4.96	5.46	5.96	6.47	6.97	7.47	7.98
42	1.09	1.69	2.28	2.87	3.46	4.05	4.64	5.23	5.82	6.41	7.00	7.59	8.18	8.77	9.36
48	1.26	1.93	2.61	3.29	3.97	4.65	5.33	6.00	6.68	7.36	8.04	8.72	9.39	10.07	10.75
54	1.42	2.18	2.95	3.72	4.48	5.25	6.01	6.78	7.54	8.31	9.08	9.84	10.61	11.37	12.14
60	1.58	2.43	3.29	4.14	4.99	5.85	6.70	7.55	8.41	9.26	10.11	10.97	11.82	12.67	13.52
66	1.74	2.68	3.62	4.57	5.51	6.45	7.39	8.33	9.27	10.21	11.15	12.09	13.03	13.97	14.91
72	1.91	2.93	3.96	4.99	6.02	7.05	8.07	9.10	10.13	11.16	12.19	13.21	14.24	15.27	16.30
78	2.07	3.18	4.30	5.41	6.53	7.65	8.76	9.88	10.99	12.11	13.22	14.34	15.46	16.57	17.69
84	2.23	3.43	4.64	5.84	7.04	8.25	9.45	10.65	11.85	13.06	14.26	15.46	16.67	17.87	19.07
90	2.39	3.68	4.97	6.26	7.55	8.85	10.14	11.43	12.72	14.01	15.30	16.59	17.88	19.17	20.46
96	2.55	3.93	5.31	6.69	8.07	9.44	10.82	12.20	13.58	14.96	16.34	17.71	19.09	20.47	21.85

HEIGHT