

**Decorative Louver in 2" thick frame design Model S-LEZ-02/series**

**Design Features** – Narrow profile multipurpose design.

**STANDARD CONSTRUCTION**

ALL MATERIAL – EXTRUDED ALUMINUM 6063-T5 (KB-45)

**FRAME**

2" square tube x .125" extruded aluminum

**BLADES**

.063" extruded aluminum, approx spacing is 3" o.c. @ 45°

**FASTENERS**

Welded construction

**MAXIMUM SIZE**

Unlimited, with mullions, structural bracing supplied by others

**MAXIMUM FACTORY ASSEMBLY SIZE**

120" w x 84" h" or 84" w x 120" h

(allows for best handling)

(Type of finish may limit maximum single section)

**MULLION**

Visible

**MINIMUM SIZE**

12" w x 8" h

**UNDERSIZED**

1/4" under ordered size unless specified Exact or Actual

**FINISH**

Mill

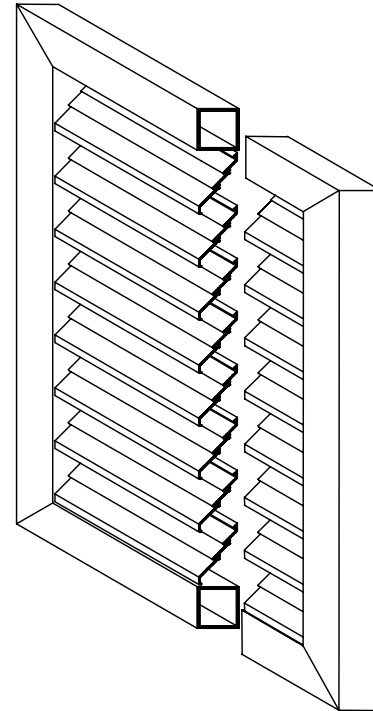

**OPTIONAL CONSTRUCTION**

**SCREEN** - Many styles available please consult screen listing

**FINISH** – Air-dry primer, polyurethane, epoxy, or enamel, baked epoxy or enamel, Kynar, or Powder coat.

**MULLION** – Invisible for architectural preference

**SPECIAL PURPOSE CONSTRUCTION**

Special shapes: Triangle, Round, Trapezoid, etc.

Fully welded construction

Security bars

Filter racks

Hinged as walk through door or for swing out for access

Sleeved for ductwork connection

\*\* Consult SAFE-AIR/DOWCO for additional technical information.

**MULLION STYLES**

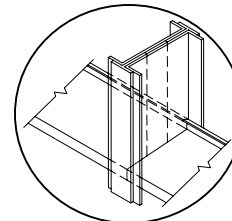

Visible

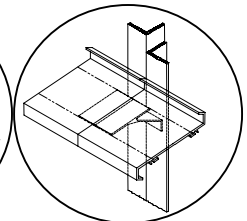

Invisible

**OPTIONAL FRAME STYLES**

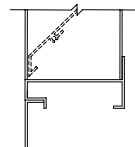

(1) - Flange  
1-1/2"

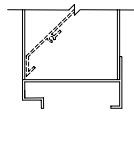

(3) - Box  
Standard

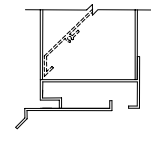

(8) - Box and  
Sill Extension

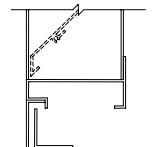

(9) - Flange  
w/ sub frame

DATE		ARCHITECT			CUSTOMER	
PROJECT						
ITEM	QTY	W	H	DESCRIPTION		