

Chevron Blade Louver in 2" thick frame design - Model LFD-02

Design Features – Sightproof design.

STANDARD CONSTRUCTION

FRAME

LFD-02" (51) thick, is 16 gauge (1.6) galvanized steel in style #2

BLADES

LFD- 02", (51) are 18 gauge (1.3) galv. steel, approx. spacing is 2" (51) @ 60°

MAXIMUM SIZE

Unlimited, with mullions, structural bracing supplied by others

MAXIMUM SINGLE SECTION

120" w x 96" H or 96" w x 120" H (3048 x 2438) or (2438 x 3048)
(allows for best handling)

MULLIONS

Visible

MINIMUM SIZE

12" W x 12" H (305 x 305)

UNDERSIZED

3/8" (10) under ordered size unless specified Exact or Actual

SCREEN

1/2" (13) wire mesh 19 gauge (1.1) galvanized bird screen no frame

FINISH

Mill

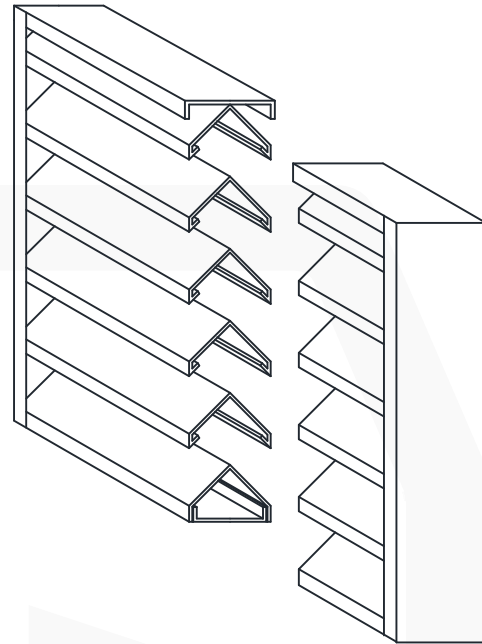

OPTIONAL CONSTRUCTION

FRAME – Available in a heavier construction up to 10 gauge (3.5)

BLADES - Available in a heavier construction up to 16 gauge (1.6)

SPECIFIED MATERIAL – Aluminum, Stainless or as requested

SCREENS - Many styles available please consult screen listing

MULLIONS – Invisible for enhanced architectural appearance.

FINISH – Air-dry primer, polyurethane, epoxy, or enamel. Baked epoxy or enamel. Kynar (Kynar limitations on steel.)

SPECIAL PURPOSE CONSTRUCTION

Special shapes; Round, Triangle, Trapezoid, Octagon, etc.

Fully welded assembly

Security bars

Filter racks

Hinged as walk through door or for swing out access

Sleeved for ductwork connection

MULLION STYLES

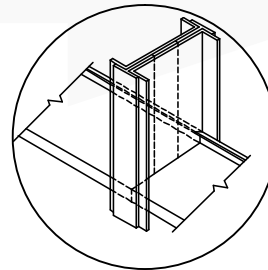

Visible

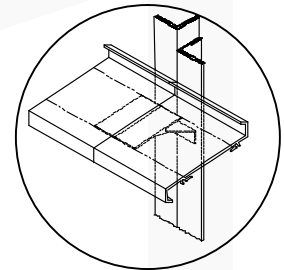

Invisible

TYPICAL SCREEN STYLES

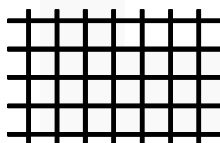

Wire Mesh
Standard

FRAME STYLE

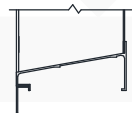

1- Flange (1.5")

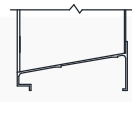

3 – Box

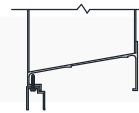

4 - Glazing
Adapter

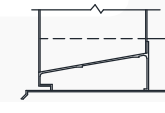

8- Box with
Sill Extension

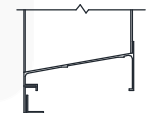

9 - Flange
w/ Sub Frame

DATE		ARCHITECT/ENGINEER			CUSTOMER	
PROJECT						
ITEM	QTY	W	H	DESCRIPTION		



DOWCO
Products Group
A division of Safe Air of Illinois
DEPENDABLE PRODUCTS SINCE 1955
DOWCO PRODUCTS GROUP
Engineering and General Offices
1855 South 54th Avenue, Cicero, Illinois 60804
Phone 708-652-9100 FAX 708-652-9158