

## Adjustable Drainable Blade Louver Model A-DWE-04 & A-DWE-06

**Design Features** – High performance adjustable design variation of our patented drainable blade configuration. Adjustable feature is useful on systems requiring periodic operation or a means of further deterring the outside element of water penetration, which is made possible when the louver is closed.

### STANDARD CONSTRUCTION

ALL MATERIAL – EXTRUDED ALUMINUM 6063-T5 (KB-45)

#### FRAME

.081" extruded aluminum in style #3

#### BLADES

A-DWE-04, (102) are .081" (2.1) extruded aluminum, 45°

A-DWE-06, (152) are .081" (2.1) extruded aluminum, 45°

#### BLADE AXLES & BEARINGS

Axles – 7/16" (11) plated steel hex

Bearings – 1/2" (13) dia. bronze oilite

#### LINKAGE

Plated steel concealed in jamb

#### MAXIMUM SIZE

Unlimited, with mullions, structural bracing supplied by others

#### MAXIMUM SINGLE SECTION

60" W x 96" H (1524 X 2438)

#### MINIMUM SIZE

12" W x 12" H (305 X 305)

#### MULLION

Visible

#### UNDERSIZED

1/4" (6) under ordered size unless specified Exact or Actual

#### SCREEN

3/4" x .051" (19 x 1.3) flattened expanded aluminum bird screen in frame mounted in the interior side.

#### FINISH

Mill

#### OPERATOR

Wing-nut type adjustable

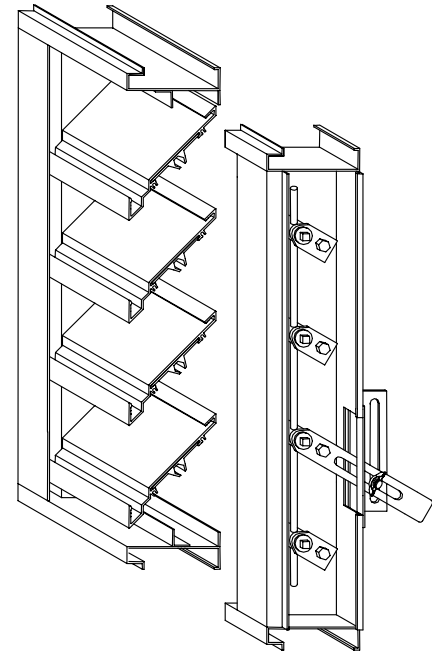

### OPTIONAL CONSTRUCTION

**FRAME** – Available in a heavier extrusion of .125" (3.2)

**BLADES** - Available in a heavier extrusion of .125" (3.2)

**BLADES & JAMB SEALS** – Vinyl blade edge and/or flexible aluminum /stainless steel jamb seals

**SCREEN** - Many styles available please consult screen listing

**LINKAGE** – Blade mounted

**FINISH** – Air-dry primer, polyurethane, epoxy, or enamel, baked epoxy or enamel, Kynar, or Powder coat.

**OPERATOR** – Electric or Pneumatic

### SPECIAL PURPOSE CONSTRUCTION

Security bars

Filter racks

Sleeved for ductwork connection

Jackshaft when required

\*\* Consult SAFE-AIR/DOWCO for additional technical information.

### TYPICAL SCREEN STYLES



Expanded Aluminum Standard

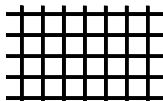

Wire Mesh

### MULLION STYLE

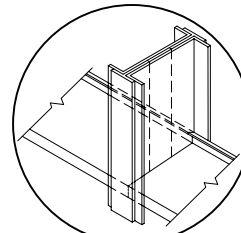

Visible

### PERFORMANCE

PERFORMANCE	
A-DWE 04	Pt. of Water Penetration <b>910 fpm</b>
	Free Area <b>50%</b> 48 x 48 unit size
A-DWE 06	Pt. of Water Penetration <b>939 fpm</b>
	Free Area <b>53%</b> 48 x 48 unit size

### FRAME STYLES

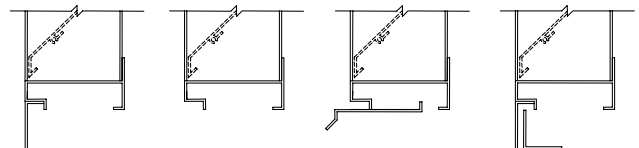

(1) - Flange 1-1/2"

(3) - Box Standard

(8) - Box and Sill Extension

(9) - Flange w/ sub frame

DATE	ARCHITECT/ENGINEER			CUSTOMER
PROJECT				
ITEM	QTY	W	H	DESCRIPTION



DEPENDABLE PRODUCTS SINCE 1955

**SAFE-AIR OF ILLINOIS INC.**

Engineering and General Offices

1855 South 54<sup>th</sup> Avenue, Cicero, Illinois 60804

Phone 708-652-9100 FAX 708-652-9158