

Adjustable Blade Louver in 4" thick frame design Model A-LEG-04

Design Features – Adjustable design variation of our traditional stepped blade configuration. Adjustable feature is useful on systems requiring periodic operation or a means of further deterring outside element penetration, which is made possible when the louver is in the closed position.

STANDARD CONSTRUCTION

ALL MATERIAL – EXTRUDED ALUMINUM 6063-T5 (KB-45)

FRAME

A-LEG- 04" (102) thick, is .081 (2.1) extruded aluminum in style #3.

BLADES

A-LEG – 04" (102) are .081" (2.1) extruded aluminum @ 45°

BLADE AXLES & BEARINGS

Axles- 7/16" Plated hex
Bearings- Bronze Oilite

LINKAGE

Concealed in jamb

MAXIMUM SIZE

Unlimited, with mullions, structural bracing supplied by others

MAXIMUM FACTORY ASSEMBLY SIZE

60" w x 96" h (1524 x 2438)
(Type of finish may limit maximum single section)

MULLION

Visible

MINIMUM SIZE

12" w x 12" H (305 x 305)

UNDERSIZED

1/4" (6) under ordered size unless specified Exact or Actual

SCREEN

3/4" x .051" (19 x 1.3) flattened expanded aluminum bird screen no frame

FINISH

Mill

OPERATOR

Wingnut adjustable

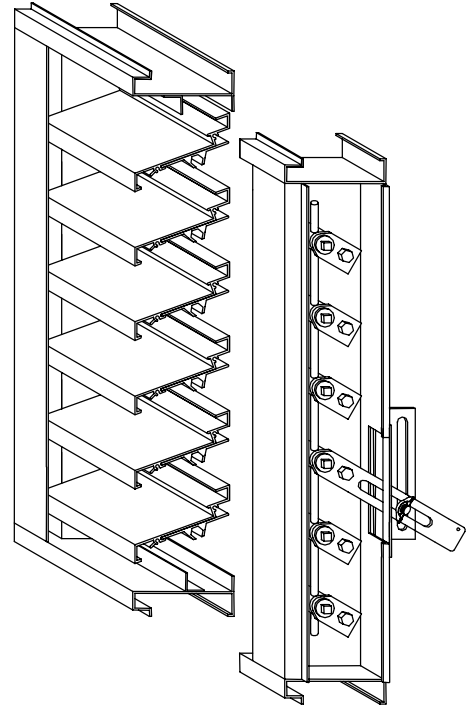

MULLION STYLES

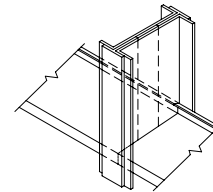

Visible

FRAME STYLES

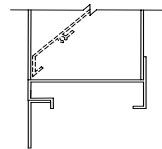

1- Flange (1.5")

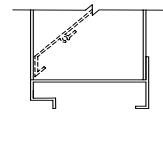

3 - Box

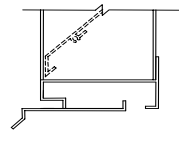

8- Box with
Sill Extension

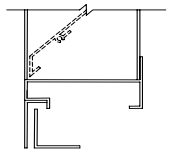

9 - Flange
with Sub Frame

SPECIAL PURPOSE CONSTRUCTION

- Fully welded construction
- Security bars
- Filter racks
- Jackshaft when required
- Sleeved for ductwork connection

TYPICAL SCREEN STYLES

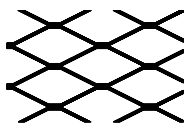

Expanded Aluminum
Standard

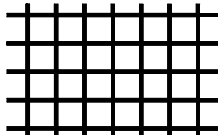

Wire Mesh

DATE	ARCHITECT	CUSTOMER		
PROJECT				
ITEM	QTY	W	H	DESCRIPTION

WIDTH FREE AREA CALCULATIONS IN SQ. FT.

INCHES	12	18	24	30	36	42	48	54	60	66	72	78	84	90	96
12	.32	.51	.70	.89	1.08	1.27	1.47	1.66	1.85	2.04	2.23	2.42	2.61	2.80	2.99
18	.56	.90	1.24	1.58	1.92	2.26	2.60	2.94	3.28	3.61	3.95	4.29	4.63	4.97	5.31
24	.81	1.30	1.78	2.27	2.76	3.24	3.73	4.22	4.70	5.19	5.68	6.16	6.65	7.13	7.62
30	1.06	1.69	2.33	2.96	3.59	4.23	4.86	5.50	6.13	6.76	7.40	8.03	8.67	9.30	9.93
36	1.30	2.08	2.87	3.65	4.43	5.21	5.99	6.78	7.56	8.34	9.12	9.90	10.68	11.47	12.25
42	1.55	2.48	3.41	4.34	5.27	6.20	7.13	8.06	8.98	9.91	10.84	11.77	12.70	13.63	14.56
48	1.80	2.87	3.95	5.03	6.10	7.18	8.26	9.33	10.41	11.49	12.57	13.64	14.72	15.80	16.87
54	2.04	3.27	4.49	5.72	6.94	8.16	9.39	10.61	11.84	13.06	14.29	15.51	16.74	17.96	19.19
60	2.29	3.66	5.03	6.40	7.78	9.15	10.52	11.89	13.27	14.64	16.01	17.38	18.76	20.13	21.50
66	2.53	4.05	5.57	7.09	8.61	10.13	11.65	13.17	14.69	16.21	17.73	19.25	20.77	22.29	23.81
72	2.78	4.45	6.11	7.78	9.45	11.12	12.79	14.45	16.12	17.79	19.46	21.12	22.79	24.46	26.13
78	3.03	4.84	6.66	8.47	10.29	12.10	13.92	15.73	17.55	19.36	21.18	22.99	24.81	26.63	28.44
84	3.27	5.23	7.20	9.16	11.12	13.09	15.05	17.01	18.98	20.94	22.90	24.86	26.83	28.79	30.75
90	3.52	5.63	7.74	9.85	11.96	14.07	16.18	18.29	20.40	22.51	24.62	26.74	28.85	30.96	33.07
96	3.76	6.02	8.28	10.54	12.80	15.06	17.31	19.57	21.83	24.09	26.35	28.61	30.86	33.12	35.38

HEIGHT