

## Weather Protective Blade Louver in 4" or 6" thick frame design - Model AFC

**Features** – Traditional adjustable design to satisfy systems requiring periodic operation.

### STANDARD CONSTRUCTION

**FRAME**

AFC-04" thick, is 18 gauge (1.3) galvanized steel in style #3  
 AFC-06" thick, is 18 gauge (1.3) galvanized steel in style #3

**ADJUSTABLE BLADES**

AFC-04" are 20 gauge (1.0) galvanized steel, 45°  
 AFC-06" are 20 gauge (1.0) galvanized steel, 45°

**BLADES AXLES & BEARINGS**

Axles – Plated shaft  
 Bearings- ½" (13) Bronze oil impregnated

**LINKAGE**

Mounted on blades at center point of width dimension

**MAXIMUM SIZE**

Unlimited, with mullions, structural bracing supplied by others

**MAXIMUM SINGLE SECTION**

60" w x 96" H (1219 x 2438) (allows for best handling)

**MULLIONS**

Visible

**MINIMUM SIZE**

12" W x 12" H (305 x 305)

**UNDERSIZED**

3/8" (10) under ordered size unless specified Exact or Actual

**SCREEN**

½" (13) wire mesh 19 gauge (1.1) galvanized bird screen in frame on face

**FINISH**

Mill

**OPERATOR**

Wingnut adjustment

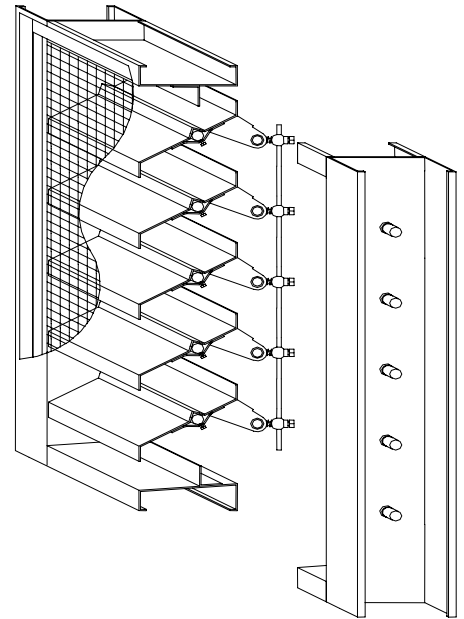

**MULLION STYLE**

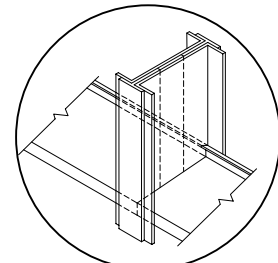

Visible

### OPTIONAL CONSTRUCTION

**FRAME** – Available in a heavier construction up to 10 gauge (3.5)

**BLADES** - Available in a heavier construction up to 12 gauge (2.7)

**SPECIFIED MATERIAL**- Aluminum, Stainless or as requested

**SCREENS** - Many styles available please consult screen listing

**LINKAGE**- Concealed inside of jamb

**OPERATOR**- Manuel, electric or pneumatic

**FINISH** – Air-dry primer, polyurethane, epoxy, or enamel. Baked epoxy or enamel.  
 Kynar ( Kynar limitations on steel.)

**BLADE & JAMB SEALS** - Neoprene blade edge & or flexible metal jamb seals

### SPECIAL PURPOSE CONSTRUCTION

Security bars

Filter racks

Hinged as walk through door or for swing out access

Sleeved for ductwork connection

### TYPICAL SCREEN STYLE

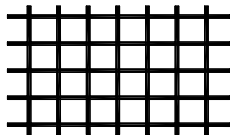

Wire Mesh  
Standard

### FRAME STYLES

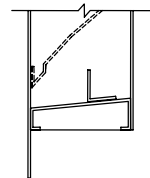

1- Flange (1.5")

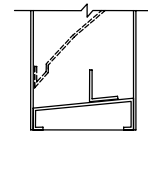

3 – Box

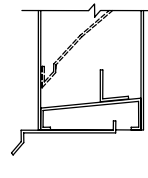

8- Box with  
Sill Extension

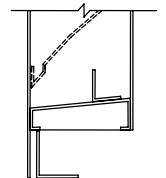

9 - Flange  
with Sub Frame

DATE	ARCHITECT			ENGINEER
PROJECT				
ITEM	QTY	W	H	DESCRIPTION



DEPENDABLE PRODUCTS SINCE 1955

**SAFE-AIR OF ILLINOIS INC.**

*Engineering and General Offices*

1855 South 54<sup>th</sup> Avenue, Cicero, Illinois 60804

Phone 708-652-9100 FAX 708-652-9158

All free area calculations made in accordance with AMCA standards.

## FREE AREA CALCULATIONS IN SQ. FT.

### WIDTH

HEIGHT	INCHES	12	18	24	30	36	42	48	54	60	66	72	78	84	90	96
	12-04	.22	.35	.49	.62	.75	.88	1.01	1.14	1.28	1.41	1.54	1.68	1.81	1.93	2.07
-06	.25	.40	.54	.69	.83	.97	1.11	1.26	1.41	1.55	1.70	1.84	1.98	2.12	2.27	
18-04	.48	.76	1.05	1.33	1.62	1.90	2.18	2.47	2.75	3.04	3.32	3.61	3.90	4.18	4.47	
-06	.49	.76	1.04	1.31	1.59	1.87	2.14	2.42	2.70	2.97	3.25	3.52	3.80	4.08	4.35	
24-04	.73	1.17	1.61	2.05	2.49	2.92	3.36	3.71	4.24	4.68	5.11	5.55	5.99	6.43	6.87	
-06	.71	1.12	1.53	1.94	2.35	2.76	3.17	3.58	3.98	4.39	4.80	5.21	5.62	6.03	6.44	
30-04	.92	1.49	2.04	2.60	3.15	3.71	4.27	4.82	5.38	5.93	6.50	7.05	7.61	8.16	8.71	
-06	.94	1.49	2.03	2.57	3.11	3.65	4.19	4.73	5.28	5.82	6.36	6.90	7.44	7.98	8.52	
36-04	1.11	1.78	2.45	3.11	3.78	4.45	5.12	5.79	6.46	7.12	7.79	8.46	9.12	9.79	10.46	
-06	1.18	1.85	2.52	3.20	3.88	4.54	5.22	5.90	6.56	7.24	7.91	8.58	9.26	9.93	10.61	
42-04	1.33	2.13	2.93	3.73	4.53	5.33	6.13	6.93	7.73	8.53	9.41	10.13	10.93	11.73	12.53	
-06	1.41	2.22	3.02	3.83	4.63	5.44	6.25	7.05	7.86	8.66	9.47	10.28	11.08	11.89	12.69	
48-04	1.59	2.54	3.50	4.45	5.40	6.35	7.30	8.26	9.21	10.16	11.11	12.07	13.02	13.97	14.92	
-06	1.67	2.61	3.56	4.51	5.74	6.41	7.36	8.31	9.27	10.21	11.16	12.11	13.07	14.01	14.96	
54-04	1.85	2.95	4.06	5.16	6.27	7.37	8.48	9.58	10.69	11.79	12.90	14.01	15.11	16.22	17.32	
-06	1.94	3.05	4.15	5.27	6.37	7.49	8.59	9.70	10.81	11.91	13.02	14.13	15.24	16.35	17.46	
60-04	2.04	3.27	4.49	5.71	6.93	8.16	9.38	10.61	11.84	13.06	14.29	15.50	16.73	17.95	19.18	
-06	2.22	3.49	4.75	6.02	7.29	8.55	9.82	11.09	12.35	13.62	14.89	16.15	17.42	18.69	19.95	
66-04	2.23	3.56	4.90	6.23	7.57	8.90	10.24	11.57	12.91	14.25	15.58	16.91	18.25	19.59	20.92	
-06	2.50	3.91	5.34	6.77	8.19	9.62	11.05	12.47	13.90	15.31	16.74	18.17	19.59	21.02	22.45	
72-04	2.45	3.91	5.38	6.85	8.31	9.78	11.25	12.72	14.19	15.66	17.12	18.59	20.06	21.52	22.99	
-06	2.77	4.35	5.93	7.52	9.10	10.69	12.27	13.86	15.44	17.02	18.60	20.19	21.77	23.35	24.93	
78-04	2.70	4.32	5.94	7.56	9.18	10.80	12.43	14.05	15.67	17.29	18.90	20.52	22.15	23.77	25.39	
-06	3.01	4.72	6.44	8.15	9.88	11.59	13.30	15.03	16.74	18.46	20.17	21.90	23.61	25.32	27.05	
84-04	2.95	4.73	6.50	8.28	10.05	11.82	13.60	15.37	17.14	18.91	20.70	22.47	24.24	26.01	27.78	
-06	3.24	5.09	6.93	8.78	10.64	12.49	14.33	16.18	18.03	19.88	21.73	23.58	25.43	27.28	29.12	
90-04	3.15	5.05	6.93	8.83	10.72	12.61	14.50	16.40	18.29	20.18	22.08	23.96	25.86	27.75	29.64	
-06	3.47	5.45	7.43	9.41	11.39	13.38	15.36	17.34	19.32	21.30	23.29	25.27	27.25	29.23	31.21	
96-04	3.34	5.34	7.34	9.35	11.35	13.35	15.36	17.36	19.36	21.37	23.37	25.37	27.38	29.38	31.38	
-06	3.70	5.81	7.92	10.04	12.15	14.27	16.38	18.50	20.61	22.72	24.84	26.95	29.07	31.18	33.30	