

Weather Protective Blade Louver in 4" or 6" thick frame design - Model AFF

Features – Traditional adjustable design to satisfy systems requiring periodic operation.

STANDARD CONSTRUCTION

FRAME

AFF-04" (102) thick, is 18 gauge (1.3) galvanized steel in style #3
 AFF-06" (152) thick, is 18 gauge (1.3) galvanized steel in style #3

ADJUSTABLE BLADES

AFF-04" (102) are 20 gauge (1.0) galvanized steel, 30°
 AFF-06" (152) are 20 gauge (1.0) galvanized steel, 30°

BLADES AXLES & BEARINGS

Axles – Plated shaft
 Bearings- ½" (13) Bronze oil impregnated

LINKAGE

Mounted on blades at center point of width dimension

MAXIMUM SIZE

Unlimited, with mullions, structural bracing supplied by others

MAXIMUM SINGLE SECTION

60" w x 96" H (1524 x 2438) (allows for best handling)

MULLIONS

Visible

MINIMUM SIZE

12" W x 12" H (305 x 305)

UNDERSIZED

3/8" (10) under ordered size unless specified Exact or Actual

SCREEN

½" (13) wire mesh 19 gauge (1.1) galvanized bird screen in frame on face

FINISH

Mill

OPERATOR

Wingnut Adjustment

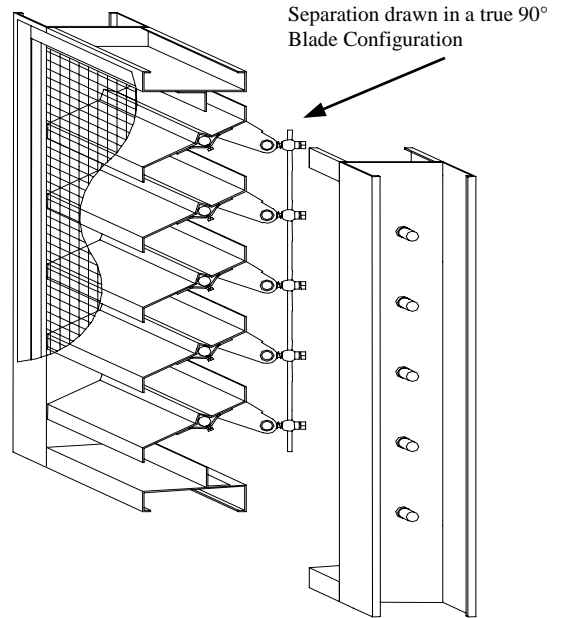

MULLION STYLE

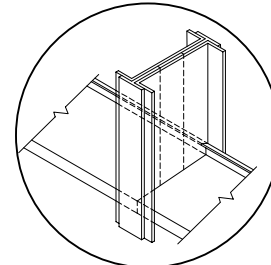

Visible

OPTIONAL CONSTRUCTION

FRAME – Available in a heavier construction up to 10 gauge (3.5)

BLADES - Available in a heavier construction up to 12 gauge (2.7)

SPECIFIED MATERIAL- Aluminum, Stainless or as requested

SCREENS - Many styles available please consult screen listing

LINKAGE- Concealed inside of jamb

OPERATOR- Manuel, electric or pneumatic

FINISH – Air-dry primer, polyurethane, epoxy, or enamel. Baked epoxy or enamel.

Kynar (Kynar limitations on steel.)

BLADE & JAMB SEALS - Neoprene blade edge and/or flexible metal jamb seals

SPECIAL PURPOSE CONSTRUCTION

Security bars

Filter racks

Sleeved for ductwork connection

Jackshaft when required

TYPICAL SCREEN STYLE

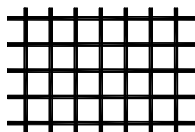

Wire Mesh
Standard

FRAME STYLES

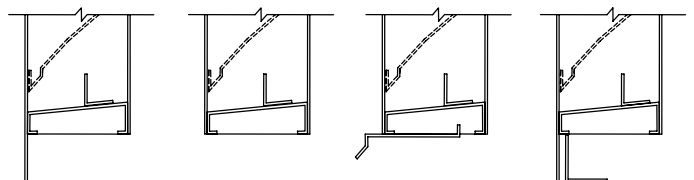

1- Flange (1.5")

3 - Box

8- Box with
Sill Extension

9 - Flange
with Sub Frame

| | | | | |
|---------|-----------|---|---|-------------|
| DATE | ARCHITECT | | | ENGINEER |
| PROJECT | | | | |
| ITEM | QTY | W | H | DESCRIPTION |
| | | | | |
| | | | | |
| | | | | |
| | | | | |
| | | | | |



DEPENDABLE PRODUCTS SINCE 1955

SAFE-AIR OF ILLINOIS INC.

Engineering and General Offices

1855 South 54th Avenue, Cicero, Illinois 60804

Phone 708-652-9100 FAX 708-652-9158

All free area calculations made in accordance with AMCA standards.

FREE AREA CALCULATIONS IN SQ. FT.

WIDTH

HEIGHT

| INCHES | 12 | 18 | 24 | 30 | 36 | 42 | 48 | 54 | 60 | 66 | 72 | 78 | 84 | 90 | 96 |
|--------------|------|------|------|-------|-------|-------|-------|-------|-------|-------|-------|-------|-------|-------|-------|
| 12-04 | .37 | .58 | .79 | 1.00 | 1.20 | 1.41 | 1.62 | 1.83 | 2.04 | 2.25 | 2.46 | 2.67 | 2.88 | 3.09 | 3.30 |
| -06 | .36 | .57 | .78 | .98 | 1.19 | 1.40 | 1.60 | 1.81 | 2.01 | 2.22 | 2.43 | 2.64 | 2.84 | 3.05 | 3.26 |
| 18-04 | .62 | .98 | 1.33 | 1.69 | 2.04 | 2.40 | 2.76 | 3.12 | 3.47 | 3.83 | 4.19 | 4.55 | 4.90 | 5.25 | 5.61 |
| -06 | .60 | .94 | 1.28 | 1.62 | 1.97 | 2.31 | 2.65 | 3.00 | 3.34 | 3.67 | 4.01 | 4.36 | 4.70 | 5.04 | 5.36 |
| 24-04 | .88 | 1.38 | 1.88 | 2.39 | 2.89 | 3.40 | 3.90 | 4.40 | 4.91 | 5.40 | 5.91 | 6.41 | 6.92 | 7.42 | 7.93 |
| -06 | .93 | 1.46 | 2.00 | 2.54 | 3.07 | 3.60 | 4.14 | 4.67 | 5.21 | 5.75 | 6.28 | 6.81 | 7.35 | 7.88 | 8.41 |
| 30-04 | 1.14 | 1.79 | 2.43 | 3.08 | 3.74 | 4.39 | 5.03 | 5.69 | 6.34 | 6.99 | 7.63 | 8.29 | 8.94 | 9.59 | 10.24 |
| -06 | 1.17 | 1.84 | 2.51 | 3.18 | 3.85 | 4.52 | 5.20 | 5.86 | 6.53 | 7.20 | 7.87 | 8.55 | 9.21 | 9.88 | 10.56 |
| 36-04 | 1.39 | 2.19 | 2.99 | 3.79 | 4.58 | 5.38 | 6.18 | 6.97 | 7.77 | 8.57 | 9.37 | 10.16 | 10.96 | 11.76 | 12.55 |
| -06 | 1.50 | 2.37 | 3.23 | 4.09 | 4.96 | 5.81 | 6.68 | 7.54 | 8.40 | 9.26 | 10.13 | 10.99 | 11.85 | 12.71 | 13.58 |
| 42-04 | 1.64 | 2.60 | 3.54 | 4.48 | 5.42 | 6.37 | 7.31 | 8.25 | 9.20 | 10.15 | 11.09 | 12.03 | 12.98 | 13.92 | 14.86 |
| -06 | 1.76 | 2.76 | 3.77 | 4.78 | 5.78 | 6.79 | 7.79 | 8.80 | 9.80 | 10.80 | 11.81 | 12.81 | 13.82 | 14.83 | 15.83 |
| 48-04 | 1.90 | 3.00 | 4.09 | 5.18 | 6.27 | 7.36 | 8.45 | 9.54 | 10.63 | 11.72 | 12.81 | 13.90 | 15.00 | 16.08 | 17.18 |
| -06 | 2.08 | 3.26 | 4.45 | 5.64 | 6.83 | 8.02 | 9.21 | 10.40 | 11.60 | 12.79 | 13.98 | 15.17 | 16.36 | 17.55 | 18.73 |
| 54-04 | 2.16 | 3.40 | 4.63 | 5.87 | 7.11 | 8.35 | 9.59 | 10.82 | 12.06 | 13.30 | 14.54 | 15.78 | 17.01 | 18.25 | 19.49 |
| -06 | 2.34 | 3.68 | 5.02 | 6.37 | 7.71 | 9.04 | 10.39 | 11.73 | 13.07 | 14.41 | 15.75 | 17.09 | 18.43 | 19.78 | 21.12 |
| 60-04 | 2.41 | 3.80 | 5.19 | 6.58 | 7.96 | 9.34 | 10.73 | 12.11 | 13.49 | 14.88 | 16.26 | 17.65 | 19.03 | 20.41 | 21.80 |
| -06 | 2.65 | 4.17 | 5.68 | 7.20 | 8.72 | 10.23 | 11.76 | 13.27 | 14.79 | 16.31 | 17.82 | 19.34 | 20.85 | 22.38 | 23.89 |
| 66-04 | 2.67 | 4.20 | 5.74 | 7.27 | 8.80 | 10.33 | 11.86 | 13.40 | 14.93 | 16.46 | 17.99 | 19.52 | 21.05 | 22.59 | 24.12 |
| -06 | 2.93 | 4.60 | 6.28 | 7.96 | 9.63 | 11.31 | 12.99 | 14.66 | 16.34 | 18.01 | 19.69 | 21.37 | 23.04 | 24.72 | 26.40 |
| 72-04 | 2.93 | 4.61 | 6.29 | 7.97 | 9.64 | 11.32 | 13.00 | 14.68 | 16.36 | 18.03 | 19.71 | 21.40 | 23.07 | 24.75 | 26.42 |
| -06 | 3.22 | 5.07 | 6.91 | 8.76 | 10.60 | 12.44 | 14.29 | 16.14 | 17.98 | 19.82 | 21.67 | 23.51 | 25.36 | 27.20 | 29.04 |
| 78-04 | 3.19 | 5.01 | 6.84 | 8.66 | 10.49 | 12.31 | 14.14 | 15.97 | 17.79 | 19.61 | 21.44 | 23.26 | 25.09 | 26.92 | 28.74 |
| -06 | 3.52 | 5.53 | 7.54 | 9.55 | 11.56 | 13.58 | 15.59 | 17.60 | 19.60 | 21.61 | 23.63 | 25.64 | 27.65 | 29.66 | 31.68 |
| 84-04 | 3.44 | 5.41 | 7.39 | 9.36 | 11.34 | 13.31 | 15.28 | 17.25 | 19.22 | 21.20 | 23.17 | 25.14 | 27.11 | 29.08 | 31.05 |
| -06 | 3.80 | 5.97 | 8.14 | 10.31 | 12.48 | 14.65 | 16.82 | 19.00 | 21.18 | 23.35 | 25.52 | 27.69 | 29.86 | 32.03 | 34.20 |
| 90-04 | 3.70 | 5.82 | 7.94 | 10.06 | 12.18 | 14.30 | 16.41 | 18.54 | 20.65 | 22.77 | 24.89 | 27.00 | 29.13 | 31.24 | 33.37 |
| -06 | 4.10 | 6.45 | 8.80 | 11.14 | 13.49 | 15.83 | 18.19 | 20.53 | 22.87 | 25.22 | 27.57 | 29.92 | 32.26 | 34.61 | 36.96 |
| 96-04 | 3.96 | 6.22 | 8.49 | 10.76 | 13.02 | 15.29 | 17.56 | 19.81 | 22.08 | 24.35 | 26.61 | 28.88 | 31.15 | 33.41 | 35.68 |
| -06 | 4.37 | 6.87 | 9.37 | 11.87 | 14.37 | 16.86 | 19.37 | 21.86 | 24.37 | 26.86 | 29.37 | 31.86 | 34.37 | 36.86 | 39.36 |