

Chevron Blade Louver in 2" deep frame design Model LEY-02

Design Features – Vision proof blade in narrow profile frame offers a clean fine lines appearance.

STANDARD CONSTRUCTION

ALL MATERIAL – EXTRUDED ALUMINUM 6063-T5 (KB-45)

FRAME

.063" thk. (1.6) extruded aluminum in style #3.

BLADES

.050" thk. (1.3) extruded aluminum, approx. spacing is 1-1/2" (38) o.c.

MAXIMUM SIZE

Unlimited, with mullions, structural bracing supplied by others

MAXIMUM FACTORY ASSEMBLY SIZE

120" w x 84" h" or 84" h x 120" w

(Type of finish may limit maximum single section)

MULLION

Invisible

MINIMUM SIZE

12" w x 12" h (305 x 305)

UNDERSIZED

1/4" (6) under ordered size unless specified Exact or Actual

SCREEN

3/4" x .051" (19 x 1.3) flattened expanded aluminum bird screen

FINISH

Mill

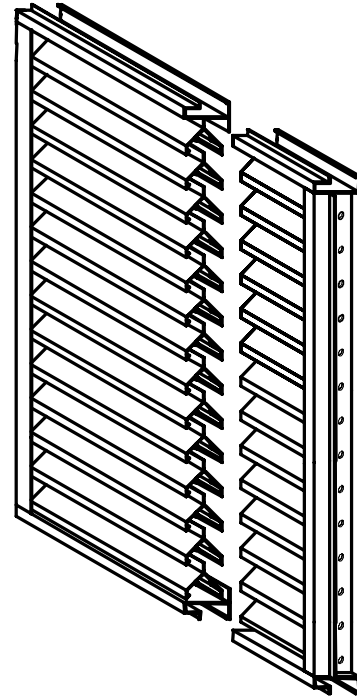

OPTIONAL CONSTRUCTION

SCREEN - Many styles available please consult screen listing

FINISH – Air-dry primer, polyurethane, epoxy, or enamel, baked epoxy or enamel, Kynar, or Powder coat.

MULLION – Visible for architectural preference

SPECIAL PURPOSE CONSTRUCTION

Special shapes: Triangle, Round, Trapezoid, etc.

Fully welded construction

Security bars

Hinged as walk through door or swing out access

Filter racks

Sleeved for ductwork connection

** Consult SAFE-AIR/DOWCO for additional technical information.

MULLION STYLES

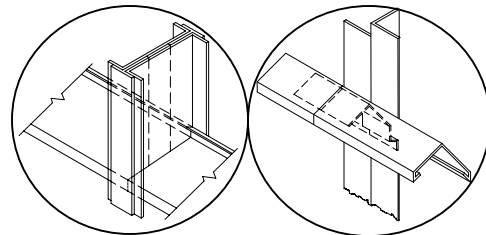

Visible

Invisible

TYPICAL SCREEN STYLES

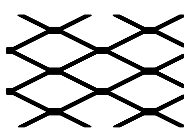

Expanded Aluminum Standard

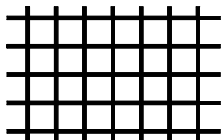

Wire Mesh

FRAME STYLES

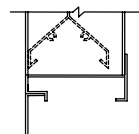

(1) - Flange 1-1/2"

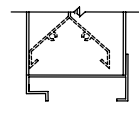

(3) - Box Standard

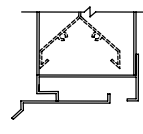

(8) - Box and Sill Extension

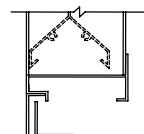

(9) - Flange w/ sub frame

DATE	ARCHITECT			CUSTOMER
PROJECT				
ITEM	QTY	W	H	DESCRIPTION



DEPENDABLE PRODUCTS SINCE 1955

SAFE-AIR OF ILLINOIS INC.

Engineering and General Offices

1855 South 54th Avenue, Cicero, Illinois 60804

Phone 708-652-9100 FAX 708-652-9158

