

## Weather Protective Blade Louver in 2", 4" or 6" thick frame design Model LFC

**Features** – Traditional design with blades fixed at a 45° angle in a clean architecturally appealing style.

### STANDARD CONSTRUCTION

#### FRAME

- LFC-02" (51) thick, is 20 gauge (1.0) galvanized steel in style #2
- LFC-04" (102) thick, is 20 gauge (1.0) galvanized steel in style #2
- LFC-06" (152) thick, is 20 gauge (1.0) galvanized steel in style #2

#### BLADES

- LFC-02", (51) are 20 gauge (1.0) galv. steel, approx. spacing is 2" (51) @ 45°
- LFC-04", (102) are 20 gauge (1.0) galv. steel, approx. spacing is 4 3/8" (111) @ 45°
- LFC-06", (152) are 20 gauge (1.0) galv. steel, approx. spacing is 6" (152) @ 45°

#### MAXIMUM SIZE

Unlimited, with mullions, structural bracing supplied by others

#### MAXIMUM SINGLE SECTION

120" w x 84" h or 84" w x 120" h  
(allows for best handling)

#### MULLIONS

Visible

#### MINIMUM SIZE

12" W x 12" H (305 x 305)

#### UNDERSIZED

3/8" (10) under ordered size unless specified Exact or Actual

#### SCREEN

1/2" (13) wire mesh 19 gauge (1.1) galvanized bird screen no frame

#### FINISH

Mill

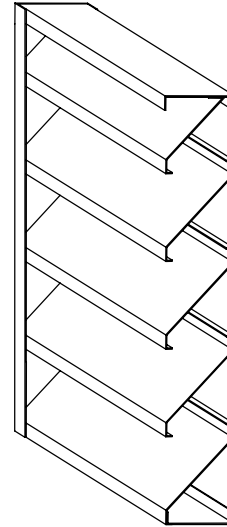

### MULLION STYLES

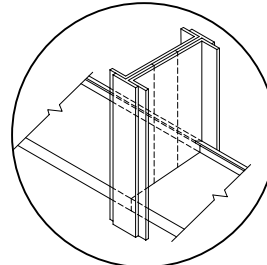

Visible

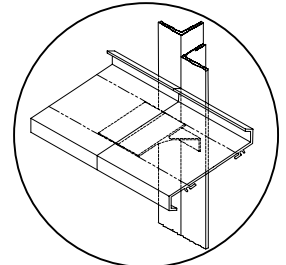

Invisible

### OPTIONAL CONSTRUCTION

**FRAME** – Available in a heavier construction up to 10 gauge (3.5)

**BLADES** – Available in a heavier construction up to 12 gauge (2.7)

**SPECIFIED MATERIAL** – Aluminum, Stainless or as requested

**SCREENS** – Many styles available please consult screen listing

**MULLIONS** – Invisible for enhanced architectural appearance.

**FINISH** – Air-dry primer, polyurethane, epoxy, or enamel. Baked epoxy or enamel. Kynar (Kynar limitations on steel.)

### SPECIAL PURPOSE CONSTRUCTION

Special shapes; Round, Triangle, Trapezoid, Octagon, etc.

Fully welded assembly

Security bars

Filter racks

Hinged as walk through door or for swing out access

Sleeved for ductwork connection

### TYPICAL SCREEN STYLE

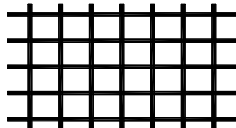

Wire Mesh  
Standard

### FRAME STYLES

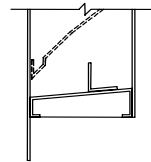

1- Flange (1.5")

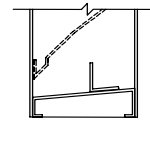

2 - Channel

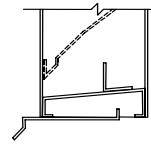

7- Channel with  
Sill Extension

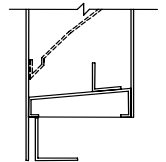

9 - Flange  
with Sub Frame

DATE	ARCHITECT			ENGINEER
PROJECT				
ITEM	QTY	W	H	DESCRIPTION



DEPENDABLE PRODUCTS SINCE 1955

**SAFE-AIR OF ILLINOIS INC.**

*Engineering and General Offices*

1855 South 54<sup>th</sup> Avenue, Cicero, Illinois 60804

Phone 708-652-9100 FAX 708-652-9158

All free area calculations made in accordance with AMCA standards.

## FREE AREA CALCULATIONS IN SQ. FT.

### WIDTH

HEIGHT	INCHES	WIDTH														
		12	18	24	30	36	42	48	54	60	66	72	78	84	90	96
12	-02	.43	.66	.89	1.12	1.35	1.59	1.82	2.05	2.28	2.51	2.75	2.98	3.21	3.44	3.68
	-04	.30	.48	.65	.82	1.00	1.17	1.34	1.52	1.69	1.86	2.04	2.21	2.39	2.56	2.73
	-06	.29	.46	.63	.79	.96	1.13	1.29	1.46	1.63	1.79	1.96	2.13	2.29	2.46	2.63
18	-02	.68	1.05	1.42	1.79	2.17	2.54	2.91	3.28	3.65	4.02	4.39	4.76	5.13	5.51	5.88
	-04	.61	.96	1.31	1.65	2.00	2.35	2.70	3.05	3.39	3.74	4.09	4.44	4.79	5.13	5.48
	-06	.56	.89	1.21	1.53	1.86	2.18	2.50	2.82	3.15	3.47	3.79	4.12	4.44	4.76	5.08
24	-02	.95	1.47	1.99	2.51	3.03	3.55	4.07	4.59	5.11	5.63	6.15	6.67	7.19	7.71	8.23
	-04	.81	1.28	1.74	2.20	2.67	3.13	3.60	4.06	4.52	4.99	5.45	5.92	6.38	6.85	7.31
	-06	.84	1.32	1.80	2.27	2.75	3.23	3.71	4.19	4.67	5.15	5.63	6.11	6.58	7.06	7.54
30	-02	1.25	1.93	2.61	3.29	3.97	4.65	5.33	6.01	6.69	7.37	8.05	8.73	9.41	10.09	10.77
	-04	1.12	1.75	2.39	3.03	3.67	4.30	4.94	5.58	6.22	6.85	7.49	8.13	8.77	9.40	10.04
	-06	1.11	1.75	2.38	3.02	3.65	4.29	4.92	5.55	6.19	6.82	7.46	8.09	8.73	9.36	10.00
36	-02	1.48	2.29	3.09	3.90	4.71	5.51	6.32	7.13	7.94	8.74	9.55	10.36	11.16	11.97	12.78
	-04	1.42	2.23	3.05	3.86	4.67	5.48	6.29	7.11	7.92	8.73	9.54	10.36	11.17	11.98	12.79
	-06	1.38	2.17	2.97	3.76	4.55	5.34	6.13	6.92	7.71	8.50	9.29	10.08	10.87	11.67	12.46
42	-02	1.79	2.76	3.74	4.71	5.68	6.66	7.63	8.61	9.58	10.56	11.53	12.51	13.48	14.45	15.43
	-04	1.62	2.55	3.48	4.41	5.34	6.27	7.19	8.12	9.05	9.98	10.91	11.83	12.76	13.69	14.62
	-06	1.66	2.60	3.55	4.50	5.44	6.39	7.34	8.29	9.23	10.18	11.13	12.07	13.02	13.97	14.91
48	-02	2.04	3.15	4.27	5.38	6.50	7.61	8.72	9.84	10.95	12.06	13.18	14.29	15.40	16.52	17.63
	-04	1.93	3.03	4.13	5.23	6.33	7.44	8.54	9.64	10.74	11.84	12.94	14.05	15.15	16.25	17.35
	-06	1.93	3.03	4.14	5.24	6.34	7.44	8.55	9.65	10.75	11.86	12.96	14.06	15.16	16.27	17.37
54	-02	2.31	3.58	4.84	6.10	7.36	8.62	9.88	11.15	12.41	13.67	14.93	16.19	17.46	18.72	19.98
	-04	2.23	3.51	4.79	6.06	7.34	8.61	9.89	11.17	12.44	13.72	15.00	16.27	17.55	18.83	20.10
	-06	2.20	3.46	4.72	5.98	7.24	8.50	9.76	11.02	12.27	13.53	14.79	16.05	17.31	18.57	19.83
60	-02	2.61	4.03	5.45	6.88	8.30	9.72	11.15	12.57	13.99	15.41	16.84	18.26	19.68	21.11	22.53
	-04	2.44	3.83	5.22	6.61	8.01	9.40	10.79	12.18	13.57	14.97	16.36	17.75	19.14	20.54	21.93
	-06	2.49	3.91	5.34	6.76	8.18	9.61	11.03	12.45	13.88	15.30	16.72	18.14	19.57	20.99	22.41
66	-02	2.84	4.39	5.94	7.49	9.04	10.59	12.14	13.69	15.23	16.78	18.33	19.88	21.43	22.98	24.53
	-04	2.74	4.31	5.87	7.44	9.00	10.57	12.13	13.70	15.27	16.83	18.40	19.96	21.53	23.10	24.66
	-06	2.80	4.40	6.00	7.60	9.21	10.81	12.41	14.01	15.61	17.21	18.81	20.41	22.01	23.61	25.22
72	-02	3.15	4.86	6.58	8.30	10.01	11.73	13.45	15.17	16.88	18.60	20.32	22.03	23.75	25.47	27.18
	-04	3.05	4.79	6.53	8.27	10.01	11.75	13.49	15.23	16.97	18.71	20.45	22.19	23.93	25.67	27.41
	-06	3.11	4.89	6.67	8.45	10.23	12.01	13.79	15.57	17.34	19.12	20.90	22.68	24.46	26.24	28.02
78	-02	3.40	5.26	7.11	8.97	10.83	12.68	14.54	16.39	18.25	20.11	21.96	23.82	25.67	27.53	29.38
	-04	3.25	5.11	6.96	8.82	10.67	12.53	14.39	16.24	18.10	19.96	21.81	23.67	25.53	27.38	29.24
	-06	3.42	5.38	7.34	9.29	11.25	13.21	15.16	17.12	19.08	21.04	22.99	24.95	26.91	28.86	30.82
84	-02	3.67	5.68	7.68	9.69	11.69	13.70	15.70	17.70	19.71	21.71	23.72	25.72	27.73	29.73	31.73
	-04	3.55	5.58	7.61	9.64	11.67	13.70	15.73	17.76	19.79	21.82	23.85	25.88	27.91	29.94	31.97
	-06	3.74	5.87	8.00	10.14	12.27	14.41	16.54	18.68	20.81	22.85	25.08	27.22	29.35	31.49	33.62
90	-02	4.00	6.19	8.37	10.55	12.73	14.92	17.10	19.28	21.47	23.65	25.83	28.02	30.20	32.38	34.57
	-04	3.86	6.06	8.27	10.47	12.68	14.88	17.08	19.29	21.49	23.70	25.90	28.11	30.31	32.52	34.72
	-06	4.03	6.33	8.63	10.93	13.23	15.53	17.84	20.14	22.44	24.74	27.04	29.34	31.65	33.95	36.25
96	-02	4.20	6.49	8.78	11.08	13.37	15.66	17.95	20.24	22.53	24.83	27.12	29.41	31.70	33.99	36.28
	-04	4.06	6.38	8.70	11.02	13.34	15.66	17.98	20.30	22.62	24.95	27.27	29.59	31.91	34.23	36.55
	-06	4.30	6.76	9.22	11.67	14.13	16.59	19.05	21.50	23.96	26.42	28.88	31.33	33.79	36.25	38.71