

ELEVATION I

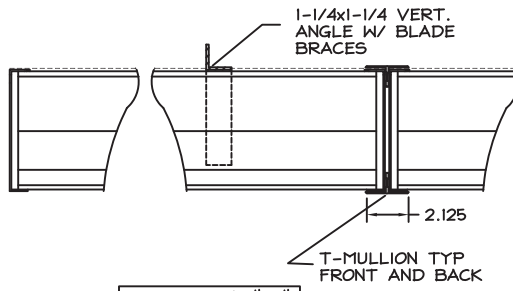

SECTION "A"

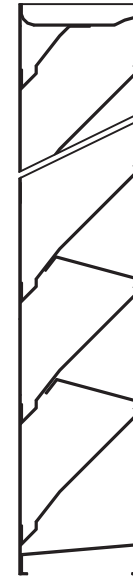

SECTION "B"

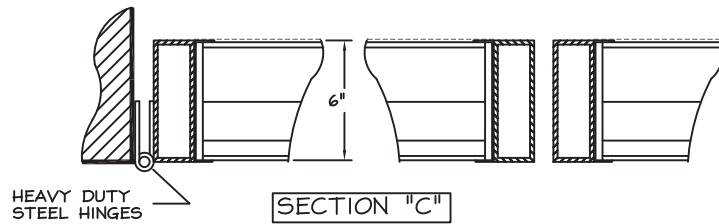

SECTION "C"

STANDARD CONSTRUCTION
 MODEL: DWF-06-3E0E-A
 FRAME: 18 GA. GALVANIZED STEEL
 BLADES: 18 GA. GALVANIZED STEEL
 FASTENERS: STL. POP RIVETS EXPOSED TO VIEW
 SCREEN: 1/2 MESH 19 GA. GALVANIZED STEEL
 FINISH: BAKED ENAMEL COLOR AS SELECTED

- NOTES:**
1. ALL LOUVERS TO BE FABRICATED 3/8" UNDER LISTED OPNG. SIZES UNLESS SPECIFIED "ACTUAL".
 2. ALL OPNG SIZES TO BE FIELD VERIFIED AND GUARANTEED BY OTHERS PRIOR TO FABRICATION.
 3. OTHER SURROUNDING FINISHES ARE FOR REFERENCES ONLY AND TO BE SUPPLIED BY OTHERS.

 **DOWCO** DEPENDABLE PRODUCTS SINCE 1955
 1855 SOUTH 54TH AVENUE, CICERO, IL. 60650

ARCH/ENGR: _____ CUSTOMER: _____

REV.	DESCRIPTION	DATE	BY	PROJECT:	TITLE:
					DWF-06/series
				DATE: _____	DRAWN: _____
				SCALE: 1:1	CHKD: _____
					DRWG #: