

FRONT ELEVATION

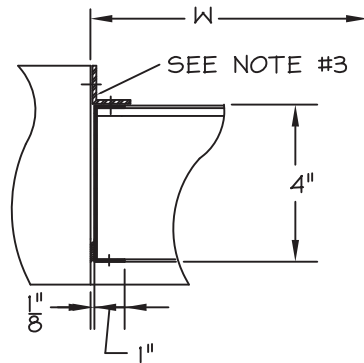

HORIZ. SECT. (A)



VERT. SECT. (B)

STANDARD CONSTRUCTION
 MODEL: UFC-04-200D-A
 FRAME: 16 GA. GALVANIZED STEEL
 BLADES: 18 GA. GALVANIZED STEEL
 SOUND INSULATION: 6# DENSITY
 PER CU. FT. MINERAL WOOL
 ASSEMBLY: PLATED RIVETS
 EXPOSED TO VIEW
 SCREEN: 1/2" MESH X 19 GA. SCREEN
 FINISH: MILL FINISH

NOTES:

1. ALL LOUVER TO BE FABRICATED PER 1/4" UNDER LISTED OPNG. SIZES UNLESS OTHERWISE SPECIFIED "ACTUAL".
2. ALL OPNG SIZES TO BE FIELD VERIFIED AND GUARANTEED BY OTHERS PRIOR TO FABRICATION.
3. SUPPORT ALL LOUVERS BY MOUNTING CLIPS (SUPPLIED BY OTHERS) @ EVERY 24" OC. OR APPROVED EQUAL.

SAFE AIR  **DOWCO**  DEPENDABLE PRODUCTS SINCE 1965
 1855 SOUTH 54TH AVENUE, CICERO, IL. 60650

ARCH/ENGR: _____ CUSTOMER: _____

PROJECT: _____ TITLE: UFC-04/SERIES

DATE: _____ DRAWN: _____ DRWG #: _____
 CHKD: _____

REV.	DESCRIPTION	DATE	BY