

Adjustable Blade Louver in 4" or 6" thick frame design Model A-LEC

Design Features –Adjustable design variation of our traditional stepped blade configuration. Adjustable feature is useful on systems requiring periodic operation or a means of further deterring outside element penetration, which is made possible when the louver is in the closed position.

STANDARD CONSTRUCTION

ALL MATERIAL – EXTRUDED ALUMINUM 6063-T5 (KB-45)

FRAME

A-LEC– 04" (102) thick, is .081" (2.1) extruded aluminum in style #3.

A-LEC– 06" (152) thick, is .081" (2.1) extruded aluminum in style #3.

BLADES

A-LEC – 04" (102) are .081" (2.1) extruded aluminum @ 45°

A-LEC – 06" (152) are .081" (2.1) extruded aluminum @ 45°

BLADE AXLES & BEARINGS

Axles- 7/16" Plated hex

Bearings- Bronze Oilite

LINKAGE

Concealed in jamb

MAXIMUM SIZE

Unlimited, with mullions, structural bracing supplied by others

MAXIMUM FACTORY ASSEMBLY SIZE

60" w x 96" h (1524 x 2438)

(Type of finish may limit maximum single section)

MULLION

Invisible

MINIMUM SIZE

12" w x 12" H (305 x 305)

UNDERSIZED

1/4" (6) under ordered size unless specified Exact or Actual

SCREEN

3/4" x .051" (19 x 1.3) flattened expanded aluminum bird screen no frame

FINISH

Mill

OPERATOR

Uc p f c t f " O c p w c i Q r g t c v q t

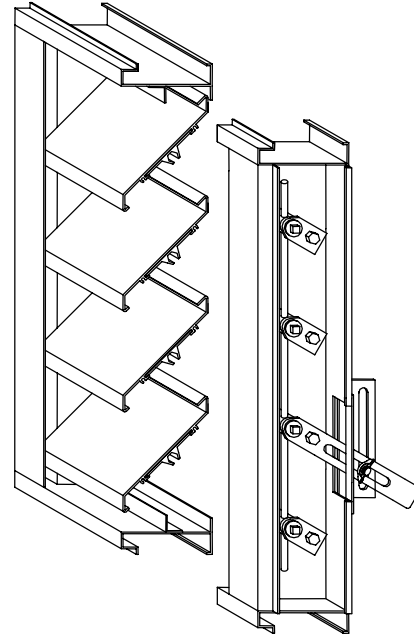

MULLION STYLES

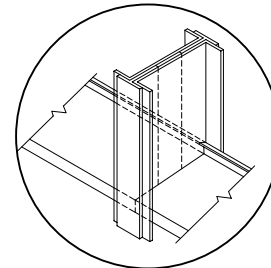

Visible

FRAME STYLE

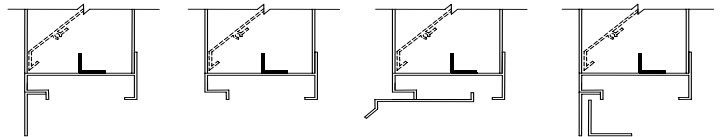

1- Flange (1.5")

3 - Box

8- Box with Sill Extension

9 - Flange with Sub Frame

OPTIONAL CONSTRUCTION

FRAME – Available in a heavier extrusion of .125" (3.2)

BLADES – Available in a heavier extrusion of .125" (3.2)

SCREEN – Many styles available please consult screen listing

FINISH – Air-dry primer, polyurethane, epoxy, or enamel. Baked epoxy, Anodize or Kynar

LINKAGE – Blade mounted

MULLION – Visible for architectural preference

OPERATOR – Wingnut

SPECIAL PURPOSE CONSTRUCTION

Fully welded construction

Security bars

Filter racks

Jackshaft when required

Sleeved for ductwork connection

TYPICAL SCREEN STYLES

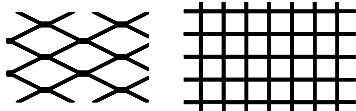

Expanded Aluminum Standard

Wire Mesh

DATE		ARCHITECT		CUSTOMER	
PROJECT					
ITEM	QTY	W	H	DESCRIPTION	



DEPENDABLE PRODUCTS SINCE 1955

SAFE-AIR OF ILLINOIS INC.

Engineering and General Offices

1855 South 54th Avenue, Cicero, Illinois 60804

Phone 708-652-9100 FAX 708-652-9158

All free area calculations made in accordance with AMCA standards.

FREE AREA CALCULATIONS IN SQ. FT.

WIDTH

HEIGHT

INCHES	12	18	24	30	36	42	48	54	60	66	72	78	84	90	96
12-04	.27	.42	.58	.73	.90	1.05	1.21	1.36	1.52	1.68	1.84	2.00	2.15	2.31	2.47
-06	.23	.36	.50	.63	.77	.90	1.04	1.17	1.30	1.45	1.58	1.71	1.85	1.99	2.12
18-04	.51	.83	1.13	1.45	1.75	2.07	2.37	2.69	3.00	3.30	3.62	3.92	4.24	4.54	4.86
-06	.46	.72	1.00	1.27	1.54	1.82	2.09	2.36	2.63	2.90	3.17	3.45	3.72	3.99	7.27
24-04	.69	1.10	1.51	1.92	2.34	2.75	3.17	3.58	3.99	4.41	4.82	5.24	5.65	6.06	6.48
-06	.69	1.09	1.50	1.90	2.31	2.72	3.13	3.54	3.95	4.36	4.77	5.18	5.59	6.00	6.41
30-04	.95	1.52	2.10	2.67	3.24	3.81	4.37	4.94	5.51	6.09	6.66	7.23	7.80	8.37	8.94
-06	.90	1.46	2.00	2.54	3.10	3.64	4.18	4.73	5.28	5.82	6.36	6.91	7.46	8.00	8.55
36-04	1.21	1.92	2.65	3.37	4.10	4.82	5.54	6.27	6.99	7.71	8.44	9.16	9.89	10.60	11.32
-06	1.13	1.82	2.50	3.18	3.87	4.55	5.23	5.91	6.60	7.28	7.96	8.65	9.32	10.01	10.70
42-04	1.38	2.20	3.03	3.86	4.69	5.50	6.33	7.16	7.99	8.81	9.64	10.47	11.30	12.12	12.94
-06	1.36	2.18	3.00	3.82	4.64	5.46	6.28	7.10	7.91	8.73	9.55	10.37	11.20	12.02	12.84
48-04	1.64	2.62	3.61	4.59	5.57	6.56	7.54	8.52	9.51	10.50	11.48	12.47	13.45	14.43	15.42
-06	1.59	2.55	3.50	4.46	5.42	6.37	7.33	8.29	9.24	10.20	11.15	12.10	13.07	14.02	14.97
54-04	1.90	3.03	4.16	5.30	6.44	7.57	8.71	9.85	10.98	12.12	13.26	14.39	15.52	16.67	17.80
-06	1.82	2.91	4.01	5.10	6.19	7.29	8.38	9.47	10.56	11.66	12.75	13.84	14.93	16.03	17.11
60-04	2.07	3.30	4.54	5.78	7.03	8.27	9.50	10.74	11.98	13.22	14.46	15.70	16.94	18.18	19.42
-06	2.05	3.28	4.50	5.73	6.97	8.20	9.43	10.66	11.89	13.11	14.34	15.57	16.80	18.03	19.26
66-04	2.32	3.72	5.12	6.52	7.91	9.31	10.71	12.10	13.50	14.90	16.30	17.70	19.10	20.50	21.89
-06	2.28	3.65	5.01	6.37	7.74	9.10	10.48	11.84	13.21	14.57	15.94	17.30	18.67	20.04	21.41
72-04	2.58	4.13	5.69	7.23	8.78	10.33	11.88	13.43	14.98	16.52	18.08	19.63	21.17	22.72	24.28
-06	2.50	4.01	5.51	7.01	8.51	10.02	11.52	13.03	14.52	16.03	17.53	19.04	20.54	22.04	23.54
78-04	2.75	4.41	6.06	7.71	9.36	11.02	12.67	14.32	15.97	17.63	19.29	20.93	22.59	24.24	25.90
-06	2.73	4.37	6.01	7.65	9.30	10.93	12.57	14.21	15.85	17.49	19.13	20.77	22.41	24.05	25.69
84-04	3.02	4.83	6.64	8.45	10.26	12.07	13.88	15.69	17.50	19.30	21.12	22.93	24.74	26.55	28.36
-06	2.96	4.73	6.51	8.29	10.07	11.84	13.62	15.40	17.17	18.95	20.72	22.50	24.28	26.06	27.83
90-04	3.27	5.24	7.20	9.16	11.12	13.09	15.05	17.01	18.97	20.89	22.91	24.86	26.82	28.78	30.74
-06	3.19	5.10	7.02	8.92	10.84	12.75	14.67	16.58	18.50	20.41	22.32	24.24	26.14	28.06	29.97
96-04	3.45	5.50	7.57	9.64	11.70	13.77	15.84	17.90	19.97	22.04	24.10	26.17	28.23	30.30	32.36
-06	3.42	5.47	7.51	9.56	11.62	13.67	15.71	17.76	19.82	21.87	23.91	25.96	28.02	30.07	32.11