

## Architectural Thin Line Louver in 1-3/8" thick frame Model LET-01

**Design Features** – Narrow profile design for weather protection of exterior equipment openings.

### STANDARD CONSTRUCTION

ALL MATERIAL – EXTRUDED ALUMINUM 6063-T5 (KB-45)

#### FRAME

.050" (1.3) extruded aluminum in style #3

#### BLADES

.125" (3.2) extruded aluminum, approx spacing is 1" (25) @ 35°

#### MAXIMUM SIZE

Unlimited, with mullions, structural bracing supplied by others

#### MAXIMUM FACTORY ASSEMBLY SIZE

72" w x 120 h" or 120" w x 72" h (1829 x 3048) or (3048 x 1829)

(allows for best handling)

(Type of finish may limit maximum single section)

#### MULLION

Visible

#### MINIMUM SIZE

12" w x 6" h (305 x 152)

#### UNDERSIZED

1/4" (6) under ordered size unless specified Exact or Actual

#### FINISH

Mill

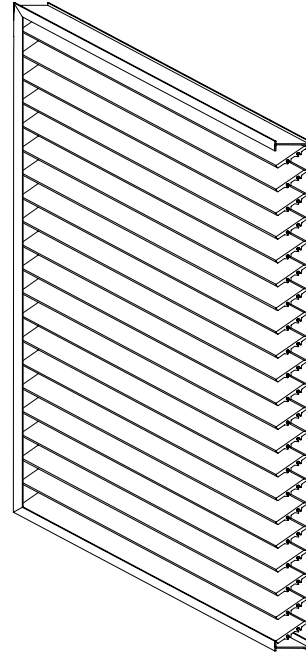

### OPTIONAL CONSTRUCTION

**FINISH** – Factory Prime Coat, Powder Epoxy, Powder Coat (AAMA 2604), Powder Coat (AAMA 2605), Kynar 500 2-step, Kynar 500 3-step, Clear Anodized 204-R1, Clear Anodized 215-R1, Bronze Anodized, Black Anodized

### SPECIAL PURPOSE CONSTRUCTION

Special shapes: Triangle, Round, Trapezoid, Octagon, etc.

Fully welded construction

Security bars

Filter racks

Hinged as walk through door or for swing out for access

Sleeved for ductwork connection

MULLION STYLE

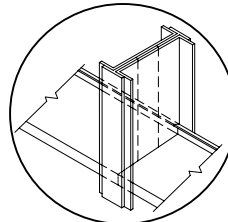

Visible

\*\* Consult SAFE-AIR/DOWCO for additional technical information.

### FRAME STYLES

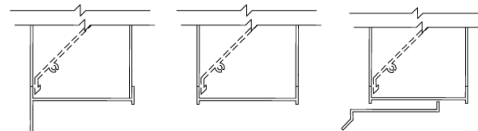

1- Flange (.75")

3 - Box

9 - Flange with Sub Frame

DATE	ARCHITECT			CUSTOMER
PROJECT				
ITEM	QTY	W	H	DESCRIPTION



DEPENDABLE PRODUCTS SINCE 1955

**SAFE-AIR OF ILLINOIS INC.**

Engineering and General Offices

1855 South 54<sup>th</sup> Avenue, Cicero, Illinois 60804

Phone 708-652-9100 FAX 708-652-9158

**WIDTH**                      **FREE AREA CALCULATIONS IN SQ. FT.**

INCHES	12	18	24	30	36	42	48	54	60	66	72	78	84	90	96
<b>12</b>	.55	.84	1.14	1.43	1.72	2.02	2.31	2.61	2.90	3.20	3.49	3.79	4.08	4.38	4.67
<b>18</b>	.85	1.31	1.77	2.23	2.69	3.14	3.60	4.06	4.52	4.98	5.44	5.90	6.35	6.81	7.27
<b>24</b>	1.15	1.78	2.40	3.02	3.65	4.27	4.89	5.51	6.14	6.76	7.38	8.00	8.63	9.25	9.87
<b>30</b>	1.46	2.25	3.03	3.82	4.61	5.39	6.18	6.97	7.75	8.54	9.33	10.11	10.90	11.69	12.47
<b>36</b>	1.76	2.71	3.66	4.62	5.57	6.52	7.47	8.42	9.37	10.32	11.27	12.22	13.17	14.12	15.08
<b>42</b>	2.07	3.18	4.30	5.41	6.53	7.64	8.76	9.87	10.99	12.10	13.22	14.33	15.45	16.56	17.68
<b>48</b>	2.37	3.65	4.93	6.21	7.49	8.77	10.04	11.32	12.60	13.88	15.16	16.44	17.72	19.00	20.28
<b>54</b>	2.67	4.12	5.56	7.00	8.45	9.89	11.33	12.78	14.22	15.66	17.11	18.55	19.99	21.43	22.88
<b>60</b>	2.98	4.59	6.19	7.80	9.41	11.01	12.62	14.23	15.84	17.44	19.05	20.66	22.26	23.87	25.48
<b>66</b>	3.28	5.05	6.83	8.60	10.37	12.14	13.91	15.68	17.45	19.22	20.99	22.77	24.54	26.31	28.08
<b>72</b>	3.59	5.52	7.46	9.39	11.33	13.26	15.20	17.13	19.07	21.00	22.94	24.87	26.81	28.75	30.68
<b>78</b>	3.89	5.99	8.09	10.19	12.29	14.39	16.49	18.59	20.69	22.78	24.88	26.98	29.08	31.18	33.28
<b>84</b>	4.19	6.46	8.72	10.99	13.25	15.51	17.78	20.04	22.30	24.57	26.83	29.09	31.36	33.62	35.88
<b>90</b>	4.50	6.93	9.35	11.78	14.21	16.64	19.06	21.49	23.92	26.35	28.77	31.20	33.63	36.06	38.48
<b>96</b>	4.80	7.39	9.99	12.58	15.17	17.76	20.35	22.94	25.54	28.13	30.72	33.31	35.90	38.49	41.08

**HEIGHT**