

Chevron Blade Louver in 1 3/8" thick frame design Model – LEY-01

Design Features – Narrow vision proof design, not intended for use as an intake or exhaust, useful in a partition as an open area vent.

STANDARD CONSTRUCTION

ALL MATERIAL – EXTRUDED ALUMINUM 6063-T5 (KB-45)

FRAME

.050" (1.3) extruded aluminum in style #3

BLADES

.050" (1.3) extruded aluminum, approx spacing is 1-1/2" (38)

MAXIMUM SIZE

Unlimited, with mullions, structural bracing supplied by others

MAXIMUM FACTORY ASSEMBLY SIZE

120" w x 84" h or 84" w x 120" h

(allows for best handling)

(Type of finish may limit maximum single section)

MULLION

Visible

MINIMUM SIZE

12" w x 6" H (305 x 152)

UNDERSIZED

1/4" (6) under ordered size unless specified Exact or Actual

SCREEN

3/4" x .051" (19 x 1.3) flattened expanded aluminum bird screen, no frame

FINISH

Mill

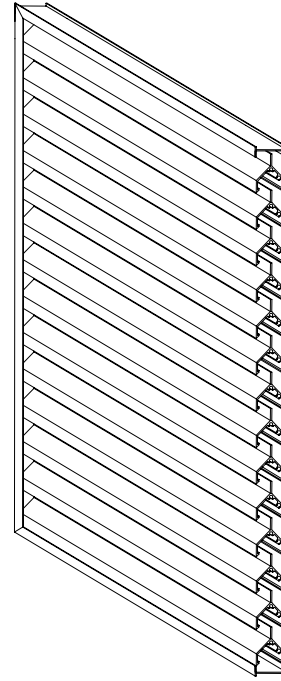

OPTIONAL CONSTRUCTION

SCREEN - Many styles available please consult screen listing

FINISH – Air-dry primer, polyurethane, epoxy, or enamel, baked epoxy or enamel, Kynar, or Powder coat.

MULLION – Invisible for architectural preference

SPECIAL PURPOSE CONSTRUCTION

Special shapes: Triangle, Round, Trapezoid, Octagon, etc.

Fully welded construction

Security bars

Filter racks

Hinged as walk through door or for swing out for access

Sleeved for ductwork connection

MULLION STYLES

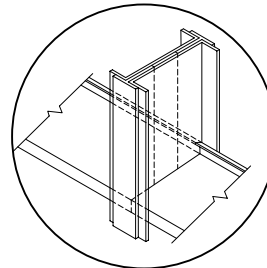

Visible

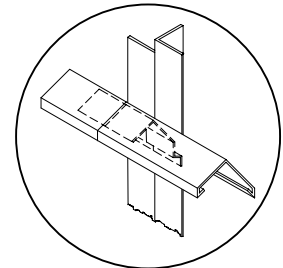

Invisible

FRAME STYLE

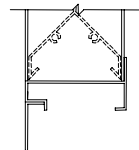

(1) - Flange
.75"

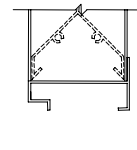

(3) - Box
Standard

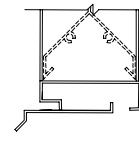

(4) - Telescoping
Flange Frame

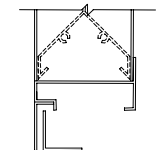

(9) - Flange
w/ sub frame

TYPICAL SCREEN STYLES

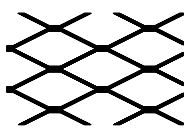

Expanded Aluminum
Standard

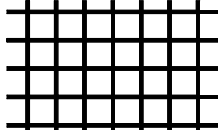

Wire Mesh

| | | | | |
|---------|-----------|---|---|-------------|
| DATE | ARCHITECT | | | CUSTOMER |
| PROJECT | | | | |
| ITEM | QTY | W | H | DESCRIPTION |
| | | | | |
| | | | | |
| | | | | |
| | | | | |
| | | | | |



DEPENDABLE PRODUCTS SINCE 1955

SAFE-AIR OF ILLINOIS INC.

Engineering and General Offices

1855 South 54th Avenue, Cicero, Illinois 60804

Phone 708-652-9100 FAX 708-652-9158

